

PRODUCT WARRANTY

A. General Warranty. PCTEL, Inc ("PCTEL") represents and warrants that the Products furnished hereunder shall be free from defects in material and workmanship for a period of two (2) years from the date of shipment by PCTEL under normal use and operation. PCTEL sole and exclusive obligation under the foregoing warranty shall be to repair or replace, at its option, any defective Product that fails during the warranty period. The expense of removal and reinstallation of any item is not included in this warranty. THE FOREGOING WARRANTY IS EXCLUSIVE AND IN LIEU OF ALL OTHER WARRANTIES, EXPRESS OR IMPLIED, INCLUDING THE IMPLIED WARRANTIES OF MERCHANTABILITY AND FITNESS FOR A PARTICULAR PURPOSE AND ANY WARRANTIES ARISING FROM A COURSE OF DEALING, USAGE OR TRADE PRACTICE WITH RESPECT TO THE PRODUCTS. Repair or replacement in the manner provided herein shall be the sole and exclusive remedy of Buyer for breach of warranty and shall constitute fulfillment of all liabilities of PCTEL with respect to the quality and performance of the Products. PCTEL reserves the right to inspect all defective Products (which must be returned by Buyer to PCTEL factory freight prepaid). No Products will be accepted for replacement or repair without obtaining a Return Materials Authorization (RMA) number from PCTEL Customer Service [by telephone: 630.372.6800 or email: antenna.techsupport@pctel.com]. Products returned without an RMA number will not be processed and will be returned to Buyer freight collect. PCTEL shall have no obligation to make repairs or replacement necessitated by catastrophe, fault, negligence, misuse, abuse, or accident by Buyer, Buyer's customers or any other parties. The warranty period of any repaired or replaced Product shall not extend beyond its original term. B. Warranty Conditions. The foregoing warranty shall apply only if: (i) the Product has been properly installed and used at all times in accordance, and in all material respects, with the applicable Product documentation; (ii) no modification, alteration or addition has been made to the Product by persons other than PCTEL or PCTEL's authorized representatives or otherwise approved by PCTEL; and (iii) the Product has not been subjected to misuse, neglect or unusual physical, electrical or electromagnetic stress, or some other type of accident. C. Disclaimer. PCTEL DOES NOT WARRANT THAT THE OPERATION OF THE PRODUCTS IS ERROR-FREE OR THAT OPERATION WILL BE UNINTERRUPTED. IN NO EVENT SHALL PCTEL BE RESPONSIBLE FOR DAMAGES OR CLAIMS OF ANY NATURE OR DESCRIPTION RELATING TO (i) SYSTEM PERFORMANCE, INCLUDING COVERAGE, (ii) BUYER'S SELECTION OF PRODUCTS FOR BUYER'S APPLICATION AND/OR (iii) FAILURE OF PRODUCTS TO MEET GOVERNMENT OR REGULATORY REQUIREMENTS.

RETURNS

In the unlikely event a defect occurs in this product, please work through the dealer or distributor from which this product was purchased. PCTEL provides complete service and support to all of its dealers and distributors.



ELEVATED FEED ANTENNA KITS INSTALLATION INSTRUCTIONS

© 2008 PCTEL, Inc.
471 Brighton Drive, Bloomington, Illinois 60108
All Rights Reserved

Part #: MIS-HIGHPERF MOUNTS-1 Rev B
Printed in the U.S.A.

INSTALLATION INSTRUCTIONS

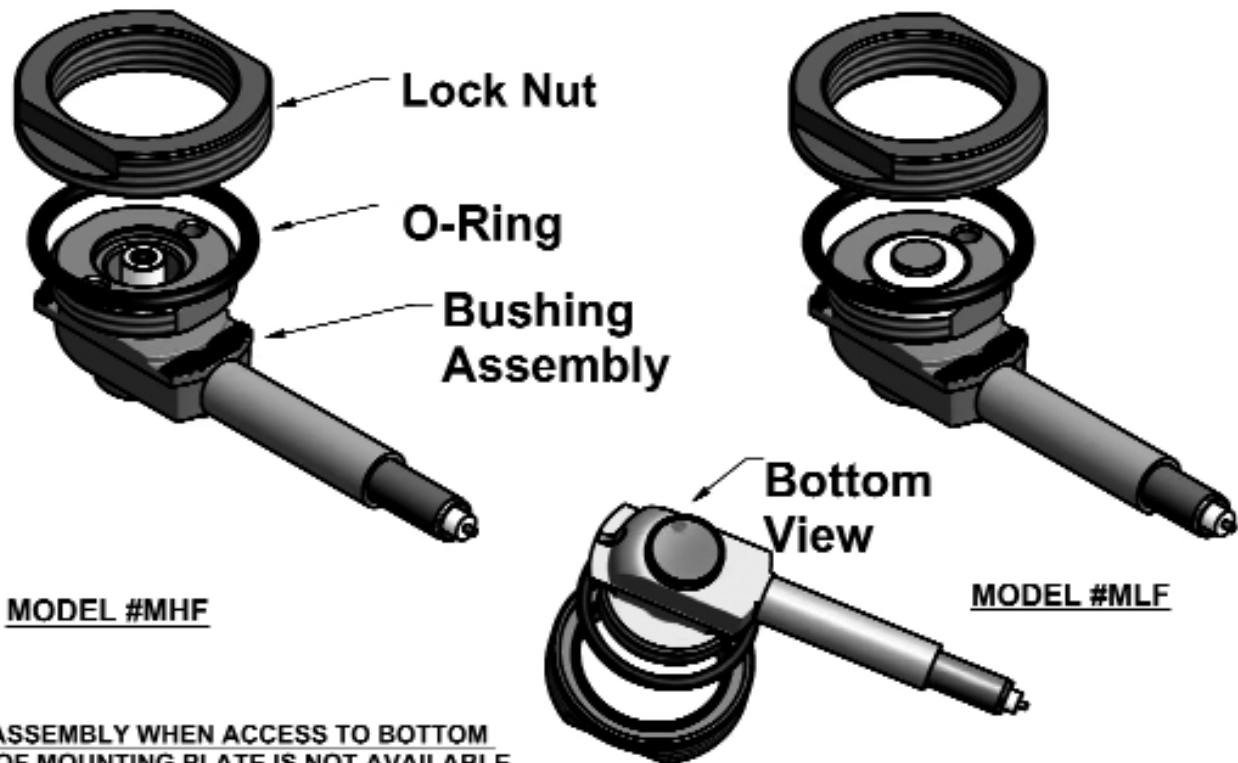

MODEL #MHF

MODEL #MLF

FOR ASSEMBLY WHEN ACCESS TO BOTTOM SIDE OF MOUNTING PLATE IS NOT AVAILABLE

1. For ease of cable routing, it is recommended that the connector not be assembled to cable end until cable is completely routed to desired location.
2. Punch/drill .75 diameter hole in mounting plate. Maximum plate thickness for M-Mounts is up to .062.
3. Feed cable through hole from top side and fish out where access is available on bottom side.
4. Assemble mount through hole from top side by angling cable side of flange through hole, slide mount as far to edge of hole as possible, dropping the opposite end of the flange through the hole and centering the mount base in the hole.
5. Assemble O-Ring into groove on brass nut (1 1/8-18 tpi M-Mount interface nut).
6. Assemble brass nut onto mount body. Tighten brass nut until O-Ring is compressed and brass nut is in contact with mounting plate. Hold mounting body from spinning using spanner wrench applied to two holes on the top of mount body.
7. Route cable to desired location and attach connector.

FOR ASSEMBLY WHEN ACCESS TO BOTTOM SIDE OF MOUNTING PLATE IS AVAILABLE

1. For ease of cable routing, it is recommended that the connector not be assembled to cable end until cable is completely routed to desired location.
2. Punch/drill .81 diameter hole in mounting plate. Maximum plate thickness for M-Mount is .062.
3. Assemble mount through hole from underside.
4. Assemble O-Ring into groove on brass nut (1 1/8-18 tpi M-Mount interface nut).
5. Assemble brass nut onto mount body. Tighten brass nut until O-Ring is compressed and brass nut is in contact with mounting plate. Hold mount body from spinning using spanner wrench applied to two holes on top of mount body or with open end wrench applied to flats of mount body underside flange.
6. Route cable to desired location and assemble connector.